

**Hotplate HP-160-700**

The SAWATEC HP-160-700 hotplate is designed for high-temperature process developments. The temperature range is designed as standard up to 700° C. The HP-160-700 offers high uniformity and process repeatability and can be used for substrates up to 140mm.

Outstanding features of the hotplate are its robust design and ease of operation. The hotplate's modular design means that it can be used in a wide range of applications with high optional expandability (wet bench integration).



HP-160-700

**FEATURES:**

- ↗ Max. substrate size 140mm
- ↗ Substrate loading: manual
- ↗ Substrat fixation via vacuum manual controlled
- ↗ Accuracy of temperature: +/-5°C (within Ø140mm)
- ↗ PLC controller with touch panel 5,7" monochrome.
- ↗ Heating ramp up possible (max. 20°C/min) max. 20 program-steps
- ↗ Pneumatic lift of the lid (water cooled)
- ↗ Stepper motor driven loading as well proximity pins (pin-circel-diameter 60mm)
- ↗ Electrical proximity adjustment
- ↗ Internal height max. 25mm max. substrat thickness 22mm

Tel: +423 377 17 90  
 Fax: +423 377 17 91  
 sales@sawatec.com  
 www.sawatec.com

SAWATEC AG  
 Industriestrasse 56  
 Postfach 514  
 FL-9491 Ruggell

For further information please contact our sales-department: sales@sawatec.com

Pictures may show standards with options.

## OPTIONS

- ⇒ Nitrogen flush controlled
  - N2-lid made of anodised aluminium
  - N2 solenoid valve

N2-LID

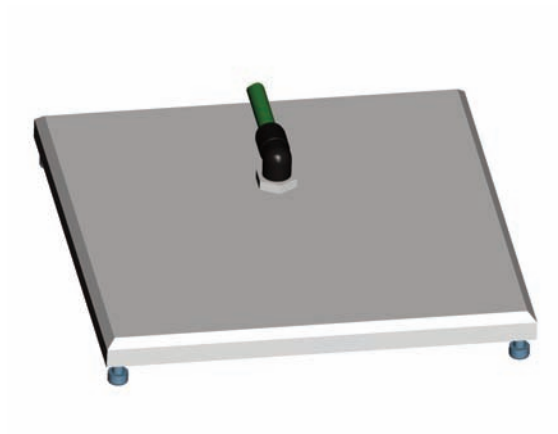

PINS

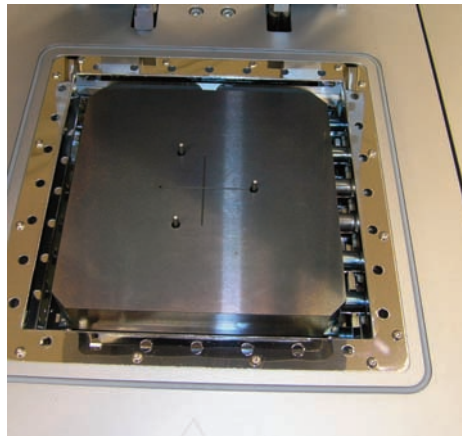

- ⇒ Temperature range: 25 - 700°C
- ⇒ Accuracy of temperature: +/-5°C (within Ø140mm)
- ⇒ Substrate loading: manual
- ⇒ Substrat fixation via vacuum
- ⇒ Max. substrate size 140mm

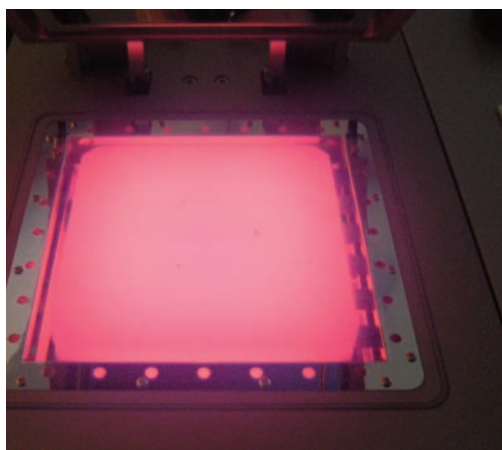

HP-160-700 by 700°C

- ⇒ 240 VAC 50/60Hz (3 kW)
- ⇒ Technical vacuum, tube Ø6/4mm
- ⇒ Exhaust connector Ø32mm
- ⇒ Cooling water 3l/min by 18°C
- ⇒ Cooling water In/Out, tube Ø8/6mm (2pcs.)
- ⇒ Compressed air 4 bar, tube Ø6/4mm

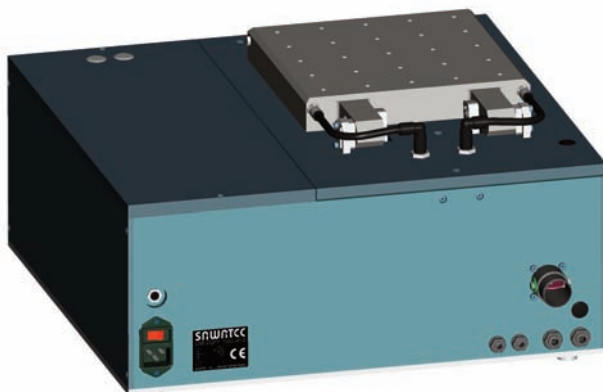

For further information please contact our sales-department: [sales@sawatec.com](mailto:sales@sawatec.com)

Pictures may show standards with options.

## PERFORMANCE

## REQUIRED MEDIA

Tel: +423 377 17 90  
 Fax: +423 377 17 91  
 sales@sawatec.com  
 www.sawatec.com

SAWATEC AG  
 Industriestrasse 56  
 Postfach 514  
 FL-9491 Ruggell

## VIEWS

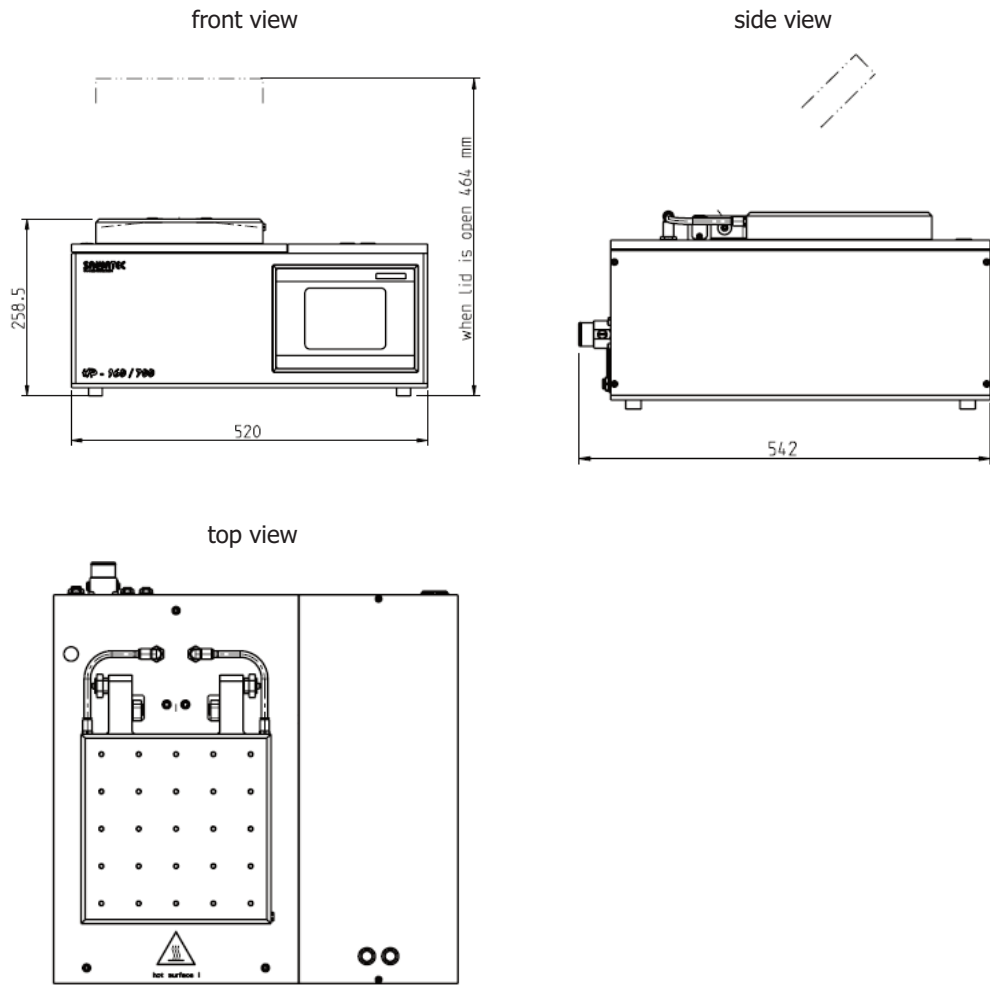

## DIMENSIONS

- ↕ Size: 520x500x260mm (LxBxH)
- ↕ Hotplate size: 160x160mm
- ↕ Weight: approx. 25 kg

## DESIGN

- ↕ Housing: Anodised aluminium (water cooled)
- ↕ Hotplate material: Inconell spez.

## DEALER

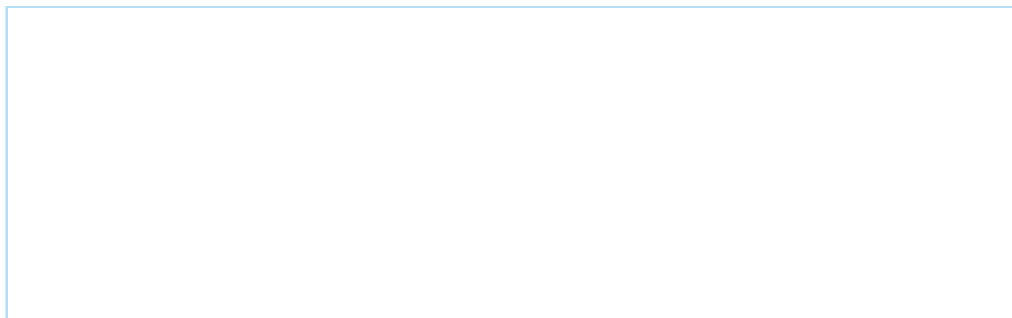

For further information please contact our sales-department: [sales@sawatec.com](mailto:sales@sawatec.com)  
 Pictures may show standards with options.

Tel: +423 377 17 90  
 Fax: +423 377 17 91  
[sales@sawatec.com](mailto:sales@sawatec.com)  
[www.sawatec.com](http://www.sawatec.com)

SAWATEC AG  
 Industriestrasse 56  
 Postfach 514  
 FL-9491 Ruggell