

Hotplate HP-401

The SAWATEC HP-401 hotplate has been developed for standard soft bake and hard bake processes in lithography and similar applications. The temperature range is designed as standard up to 250° C. The HP-401 offers high uniformity and process repeatability and can be used for substrates up to 300mm.

The hotplate comes as standard with proximity pins and loading pins, allowing simultaneous processing of five substrates (up to 100mm).

Outstanding features of the hotplate are its robust design and ease of operation. The hotplate's modular design means that it can be used in a wide range of applications with high optional expandability (wet bench integration).



HP-401

FEATURES:

- ↪ Digital temperature controller with actual-and nominal value
- ↪ Heating ramp up possible with 20 program-steps
- ↪ Pneumatic lift of the lid
- ↪ Pneumatic driven loading as well as proximity pins
- ↪ Manual adjustable proximity pins between 0-1mm (0.1mm increments)
- ↪ Pin made of Inconel with ceramicball
- ↪ Pin-circle-diameter Ø45mm
- ↪ Internal height max. 23mm : max. substrate thickness 20mm
- ↪ Max. substrate size 1x300mm or 5x100mm
- ↪ Substrate loading: manual
- ↪ Substrate fixation via vacuum

Tel: +423 377 17 90
 Fax: +423 377 17 91
 sales@sawatec.com
 www.sawatec.com

SAWATEC AG
 Industriestrasse 56
 Postfach 514
 FL-9491 Ruggell

For further information please contact our sales-department: sales@sawatec.com

Pictures may show standards with options.

OPTIONS

- ⇒ Nitrogen flush controlled
 - N2-lid made of anodised aluminium
 - N2 solenoid valve
- ⇒ Protection glass with pins

PROTECTION GLASS

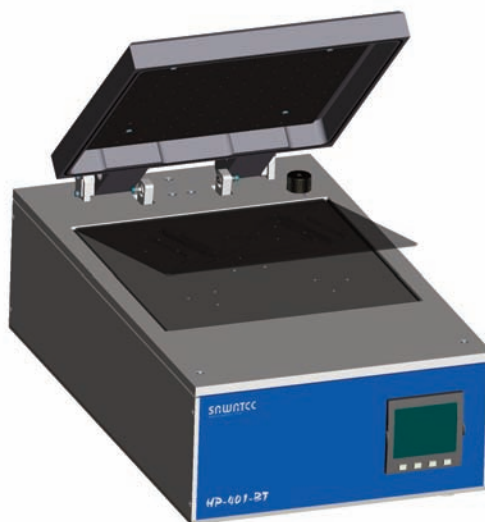

N2-LID

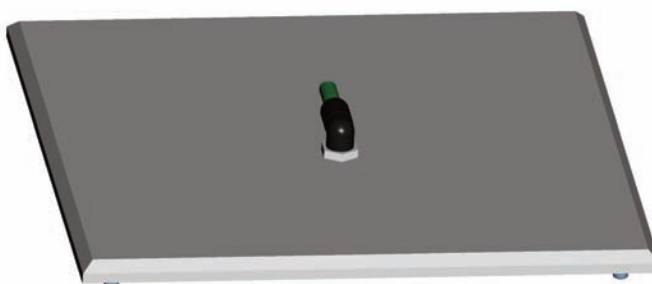

↔	Temperature range:	25 - 250°C
↔	Accuracy of temperature:	+/-1°C per 100°C
↔	Substrate loading:	manual
↔	Substrate fixation via vacuum	
↔	Max. substrate size:	1x300mm or 5x100mm
↔	Internal height max. 23mm:	max. substrate thickness 20mm (without protective glass and proximity pins)

PERFORMANCE

- ↔ 240 VAC 50/60Hz (1500W)
- ↔ Technical vacuum, tube Ø6/4mm
- ↔ Compressed air 4 bar, tube Ø6/4mm
- ↔ Exhaust connector Ø32mm

REQUIRED MEDIA



For further information please contact our sales-department: sales@sawatec.com

Pictures may show standards with options.

Tel: +423 377 17 90
 Fax: +423 377 17 91
 sales@sawatec.com
 www.sawatec.com

SAWATEC AG
 Industriestrasse 56
 Postfach 514
 FL-9491 Ruggell

VIEWS

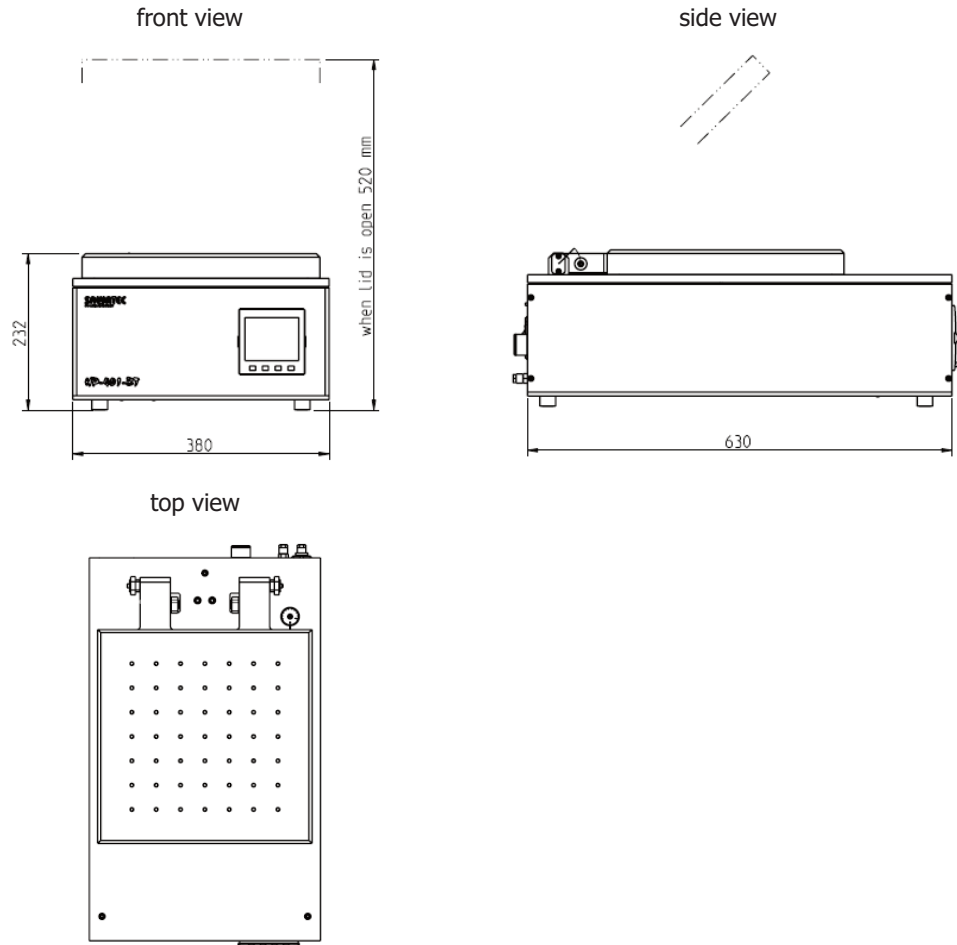

DIMENSIONS

- ⇒ Size: 380x630x240mm (LxBxH)
- ⇒ Hotplate size: 320x320mm
- ⇒ Weight: approx. 37kg

DESIGN

- ⇒ Housing: Anodised aluminium
- ⇒ Hotplate material: Anodised aluminium

DEALER

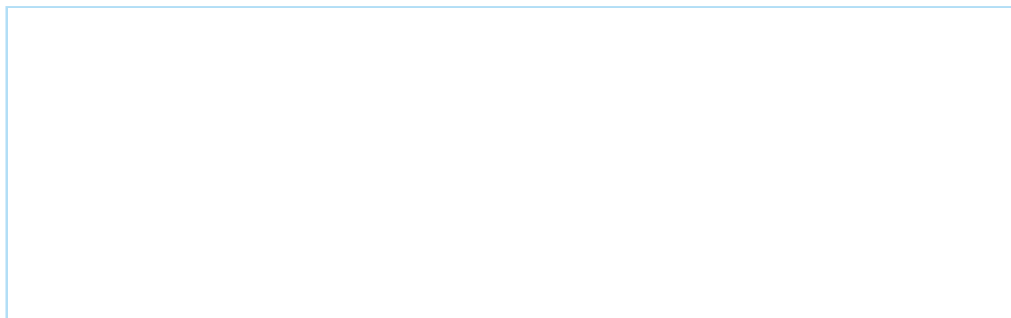

Tel: +423 377 17 90
 Fax: +423 377 17 91
 sales@sawatec.com
 www.sawatec.com

SAWATEC AG
 Industriestrasse 56
 Postfach 514
 FL-9491 Ruggell

For further information please contact our sales-department: sales@sawatec.com

Pictures may show standards with options.